

# Mini-PC

pcma-001  
pcma-002

Installation guide

# Scape® Hardware

## Installation guide

### Contents

<b>1. Connections and controls</b>	<b>4</b>
1.1. Front	4
1.2. Back	5
<b>2. Wiring</b>	<b>6</b>
2.1. Capore® / Scape X® touch and object recognition	6
2.2. Windows touch	7
<b>3. Technical specifications</b>	<b>8</b>
3.1. Mini-PC 3060	8
3.2. Mini-PC 3070	9
<b>4. Technische Zeichnungen</b>	<b>10</b>
4.1. Perspective	10
4.2. Top view	11
4.3. Front view	12
4.4. Back view	13
4.5. Left view	14
4.6. Bottom view	15
<b>5. Troubleshooting tips</b>	<b>16</b>
5.1. Manufacturer – Support	16

## Notes

**This document provides graphics for the correct wiring of a Scape® Tangible with a Silent PC for operation with Windows Touch or Capore® / Scape X® Touch and object recognition.**

This manual is applicable for the following devices:

- Mini-PC 3060 (pcma-001)
- Mini-PC 3070 (pcma-002)

Information in this document is subject to change without notice.

©2021 Interactive Scape GmbH. All rights reserved.

The document or excerpts from the document may not be duplicated without the prior permission of Interactive Scape GmbH.

Interactive Scape GmbH shall not be liable for any errors contained in this document or any other incidental or consequential damages resulting from the delivery, use or application of this material.

All product names mentioned in this document are trademarks or registered trademarks of their respective owners.

# 1. Connections and controls

## 1.1. Front

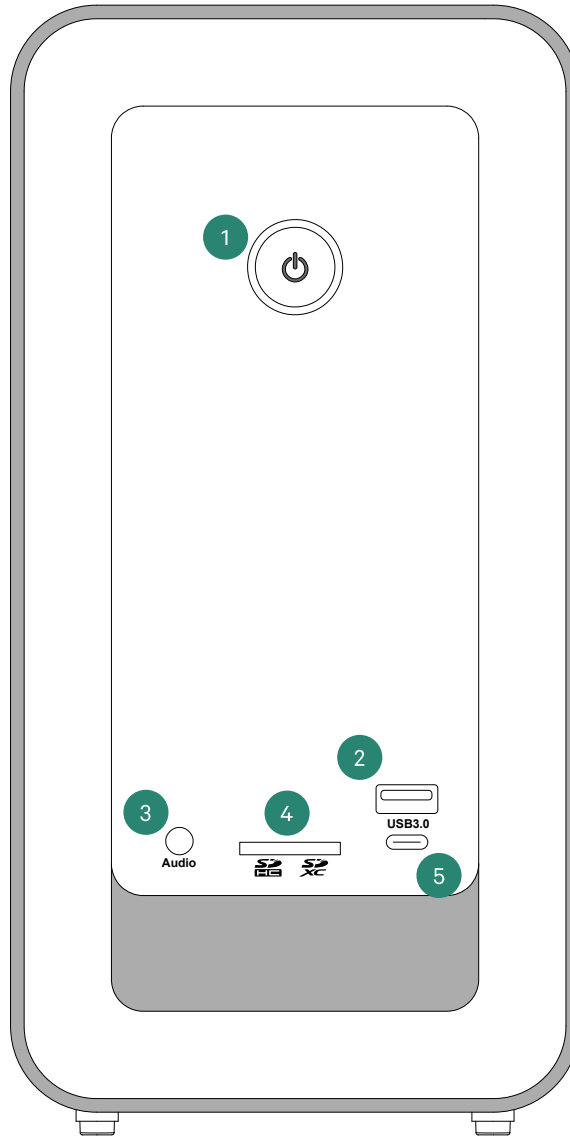

1	Switch PC on / off
2	USB 3.0 (type A)
3	Audio output / Microphone input (3.5mm jack)
4	SD(HC/XC)-Slot
5	USB 3.1 (type C)

## 1.2. Back

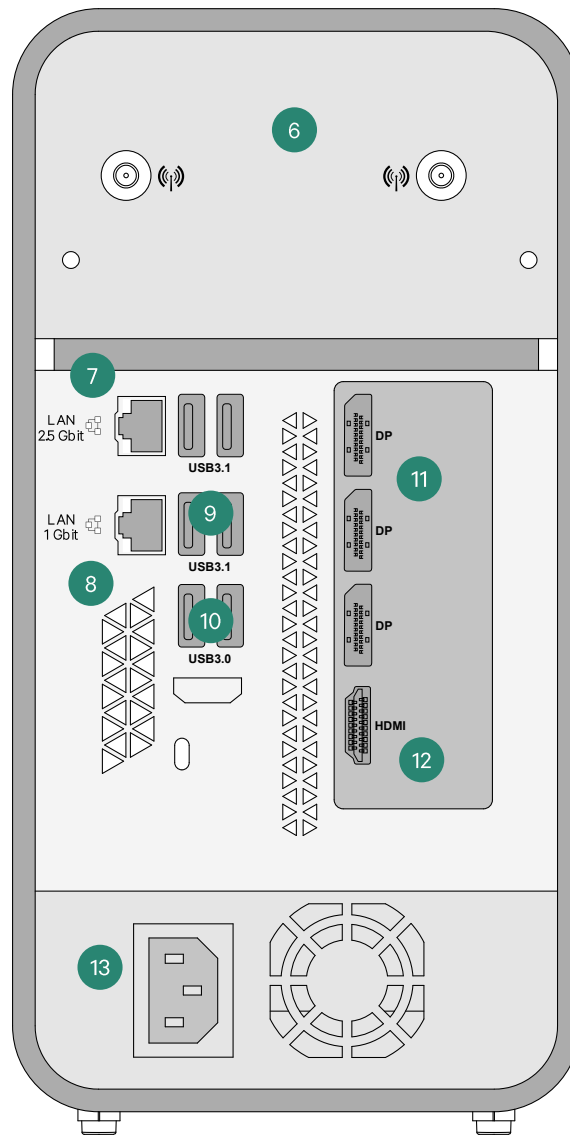

6	2x external WIFI antennas
7	2.5 Gigabit Ethernet (external)
8	1 Gigabit Ethernet ( internal – Scape Tangible®)
9	4x USB 3.1 (type A)
10	2x USB 3.0 (type A)
11	3x DisplayPort 1.4
12	HDMI 2.0 (HDMI 2.1 – Mini-PC 3070 only)
13	Power supply

## 2. Wiring

### 2.1. Capore® / Scape X® touch and object recognition

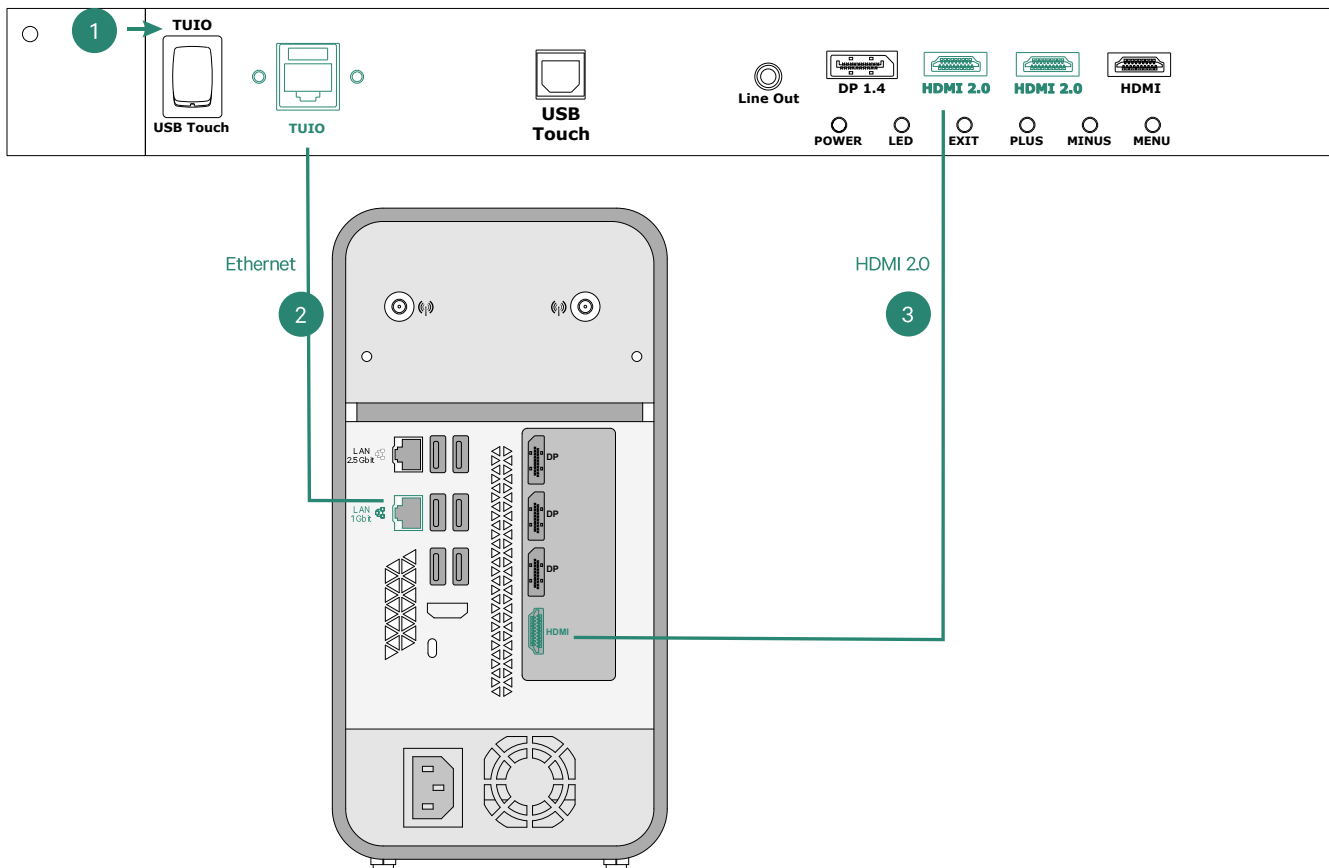

- |   |   |
|---|---|
| 1 | Set switch to TUIO                                  |
| 2 | Establishing a network connection (RJ45 connector)* |
| 3 | Establishing an HDMI 2.0 connection                 |

\* PC network settings:  
 IPv4 address: 10.0.0.21  
 Subnet mask: 255.255.255.0

## 2.2. Windows touch

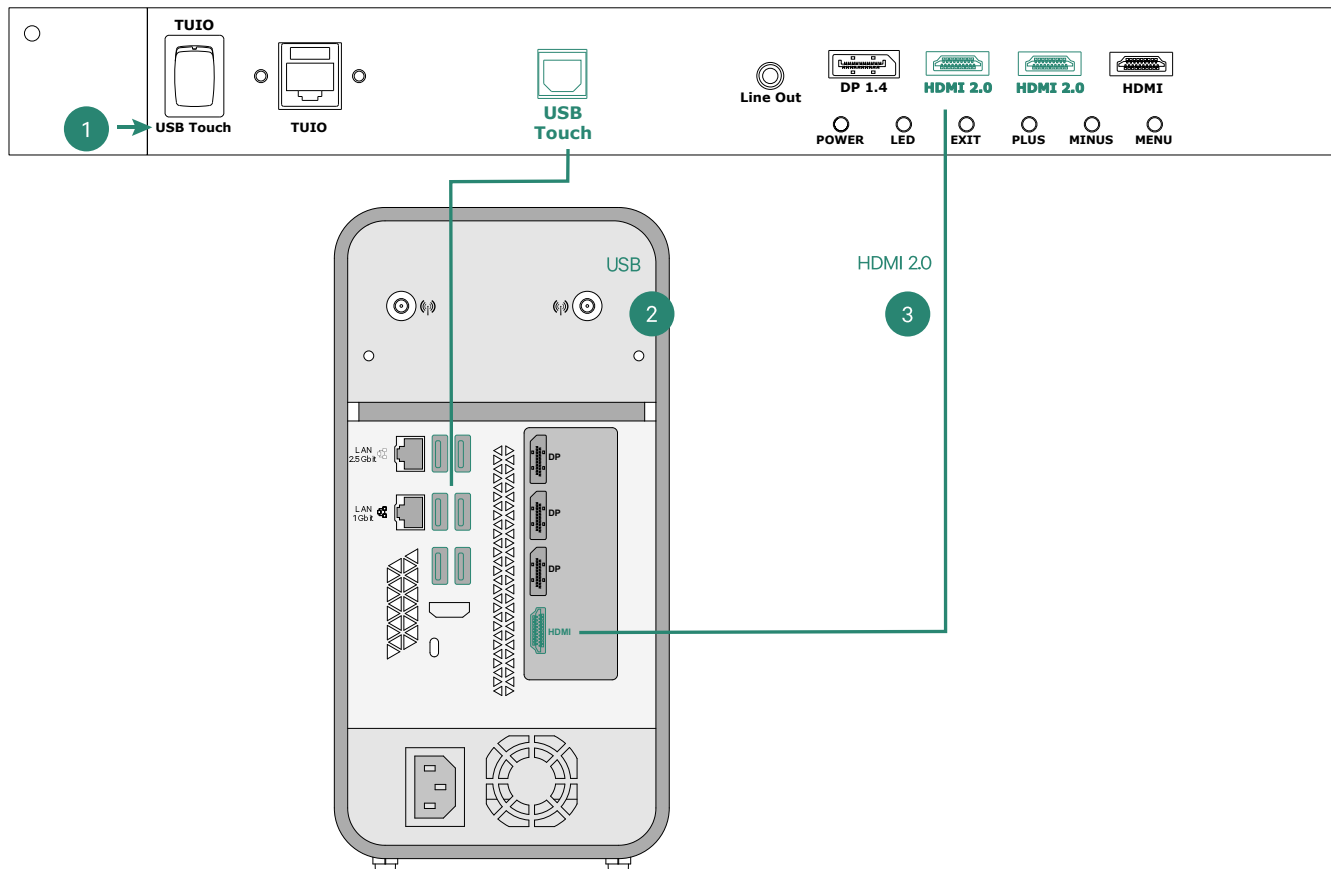

- |   |  |
|---|--|
| 1 | Set switch to USB Touch                          |
| 2 | Establishing a USB Connection (USB A-to-B Cable) |
| 3 | Establishing an HDMI 2.0 connection              |

## 3. Technical specifications

### 3.1. Mini-PC 3060

Article Number	pcma-001
<b>Specifications</b>	
Processor	Intel Core i7-10400 six-core 2.9 - 4.3 GHz
RAM	16 GB (Dual Channel)
Hard drive	250 GB SSD M.2
Graphics Card	NVIDIA Geforce RTX 3060 12GB GDDR6
Sound	Onboard 8 Channel Digital Audio via HDMI Mic/Speaker output
<b>Ports</b>	
Display	1x HDMI 2.0 / 3x DisplayPort 1.4
Network	WiFi 6 Killer AX1650 / 1x Killer 2.5 Gbps LAN / 1x Gigabit LAN / Bluetooth 5
USB	4x USB 3.1 Type A, 3x USB 3.0 Type A, 1x USB 3.0 Type C
<b>Other</b>	
Dimensions (LxWxH)	265.5 x 126 x 249 mm
Power Supply	internal power supply unit
Operating voltage	100 – 240 VAC
Power draw	500 W
Operating System	Windows 10 Professional
	not suitable for 24/7 operation



## 3.2. Mini-PC 3070

Article Number	pcma-002
<b>Specifications</b>	
Processor	Intel Core i7-10700 8-core 296 – 4.8 GHz
RAM	16 GB (Dual Channel)
Hard drive	250 GB SSD M.2
Graphics Card	NVIDIA Geforce RTX 3070 8GB GDDR6
Sound	Onboard 8 Channel Digital Audio via HDMI Mic/Speaker output
<b>Ports</b>	
Display	1x HDMI 2.1 / 3x DisplayPort 1.4
Network	WiFi 6 Killer AX1650 / 1x Killer 2.5 Gbps LAN / 1x Gigabit LAN / Bluetooth 5
USB	4x USB 3.1 Type A, 3x USB 3.0 Type A, 1x USB 3.0 Type C
<b>Other</b>	
Dimensions (LxWxH)	265.5 x 126 x 249 mm
Power Supply	internal power supply unit
Operating voltage	100 – 240 VAC
Power draw	500 W
Operating System	Windows 10 Professional
	not suitable for 24/7 operation

## 4. Technische Zeichnungen

### 4.1. Perspective

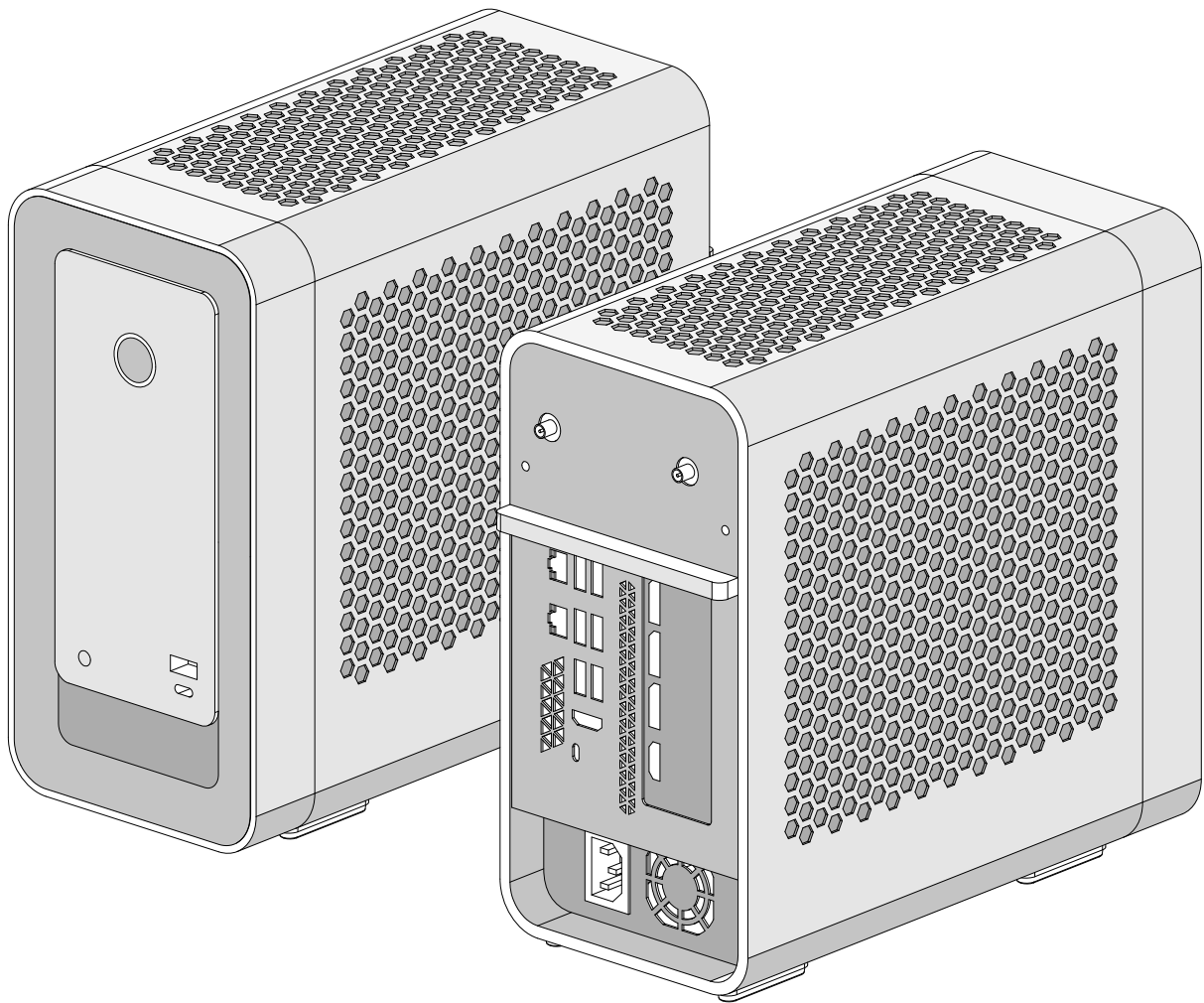

## 4.2. Top view

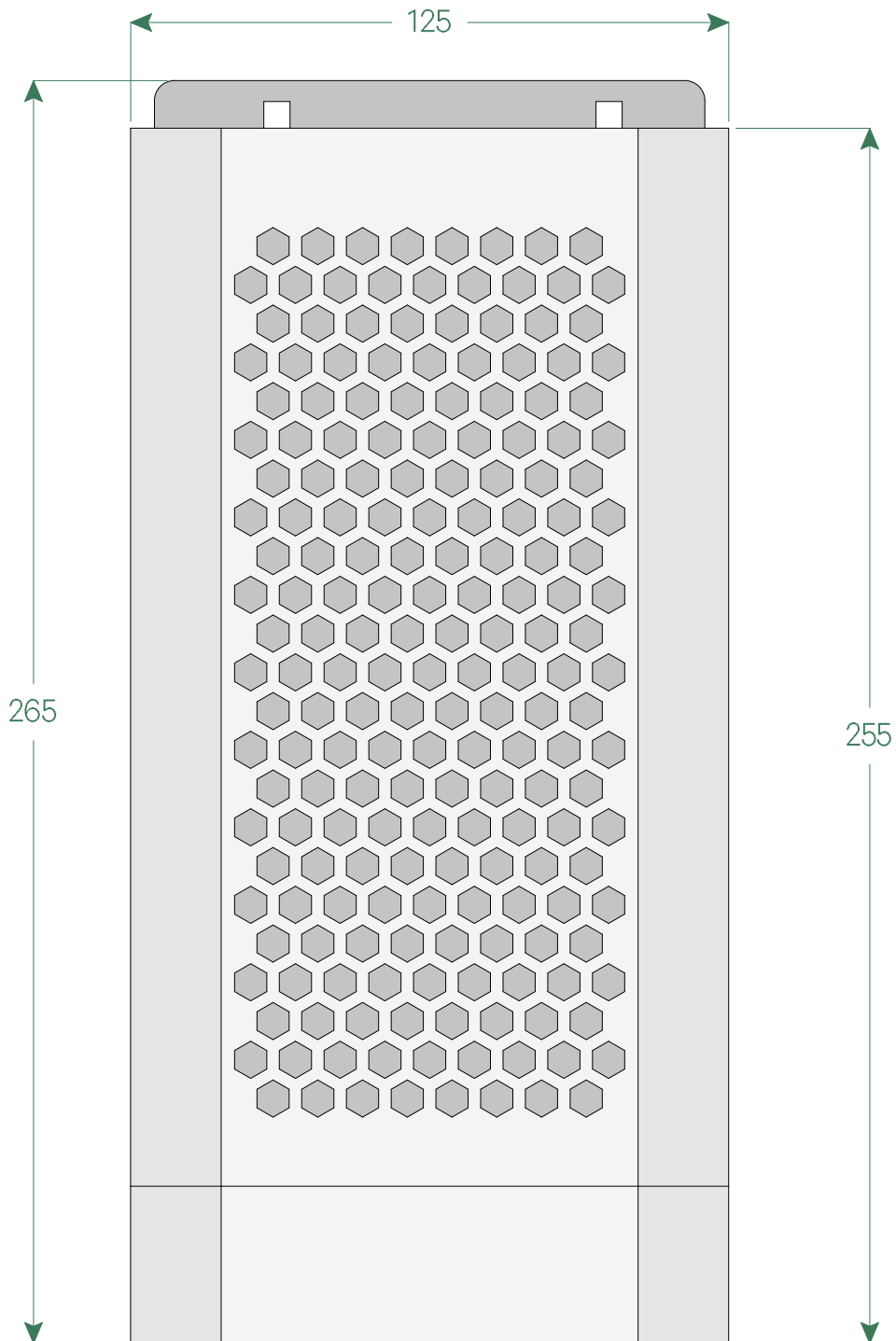

### 4.3. Front view

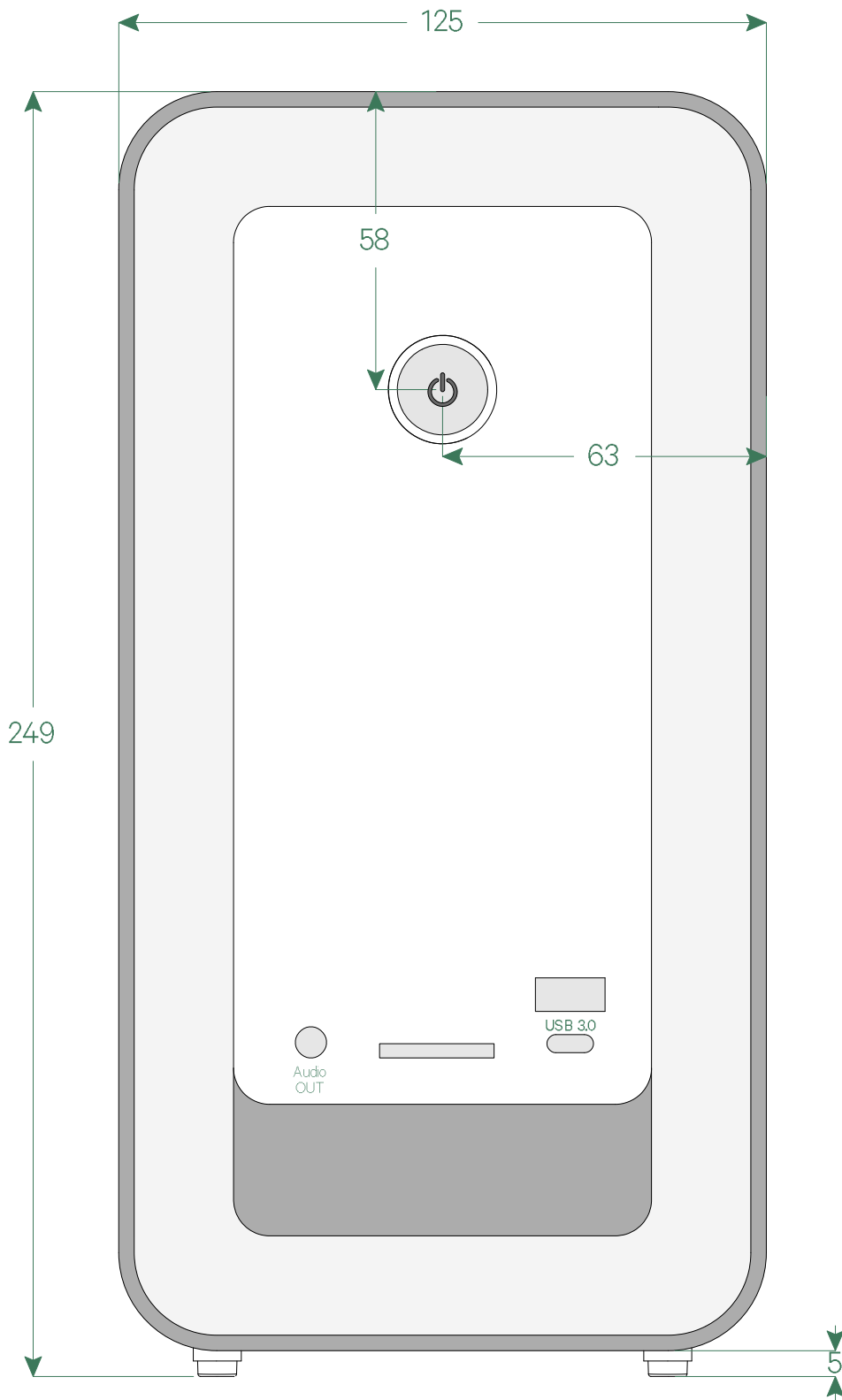

### 4.4. Back view

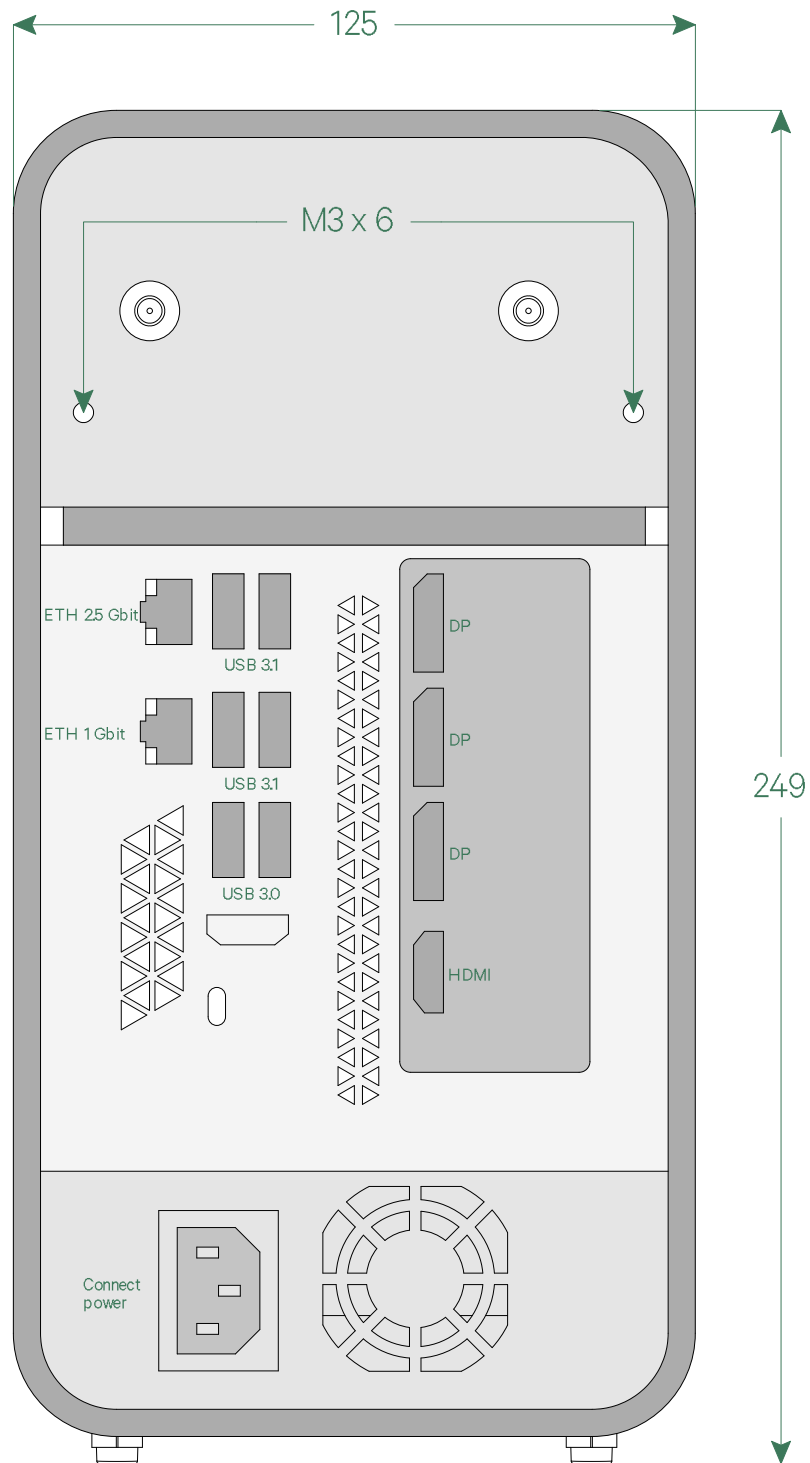

### 4.5. Left view

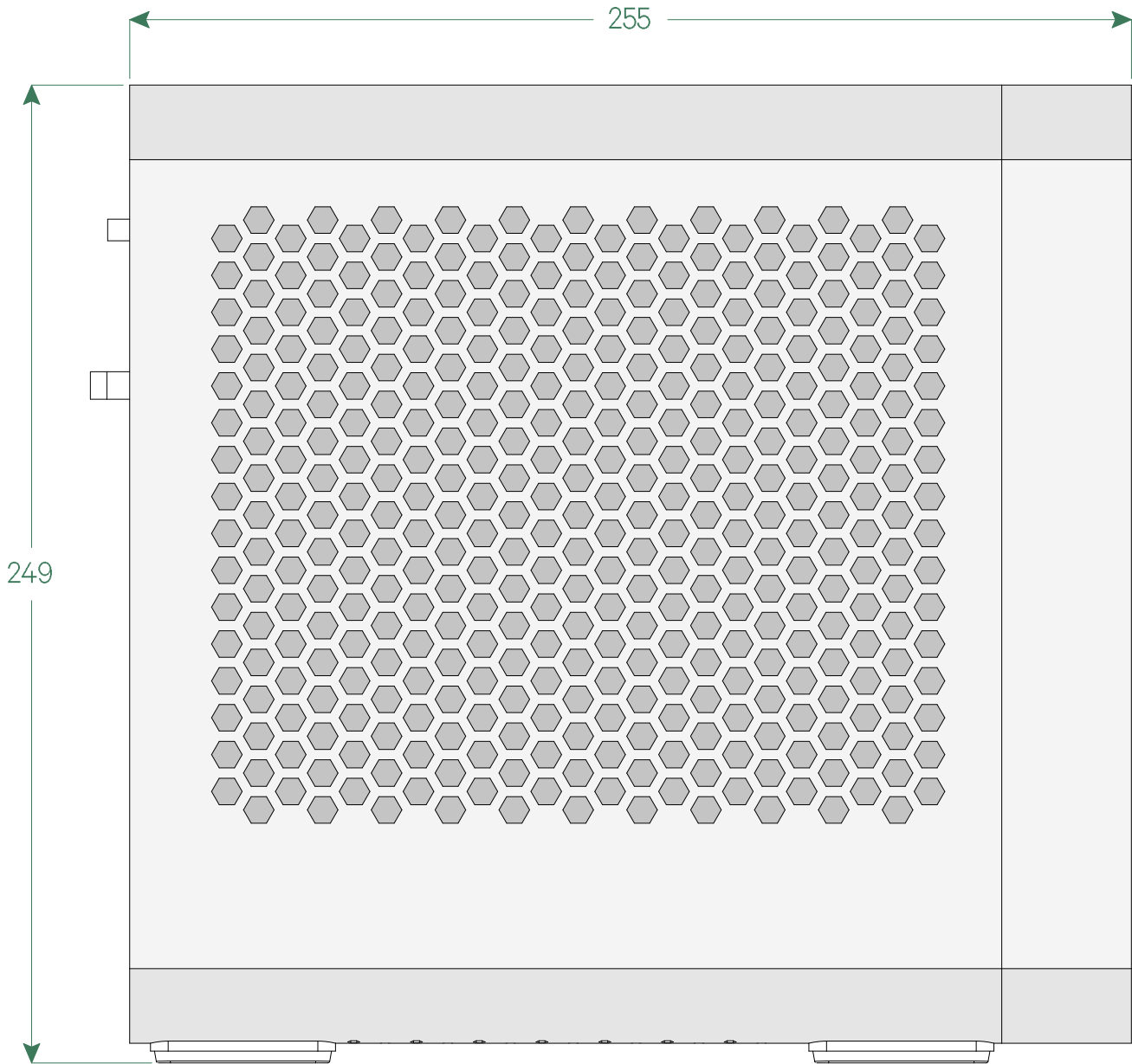

### 4.6. Bottom view

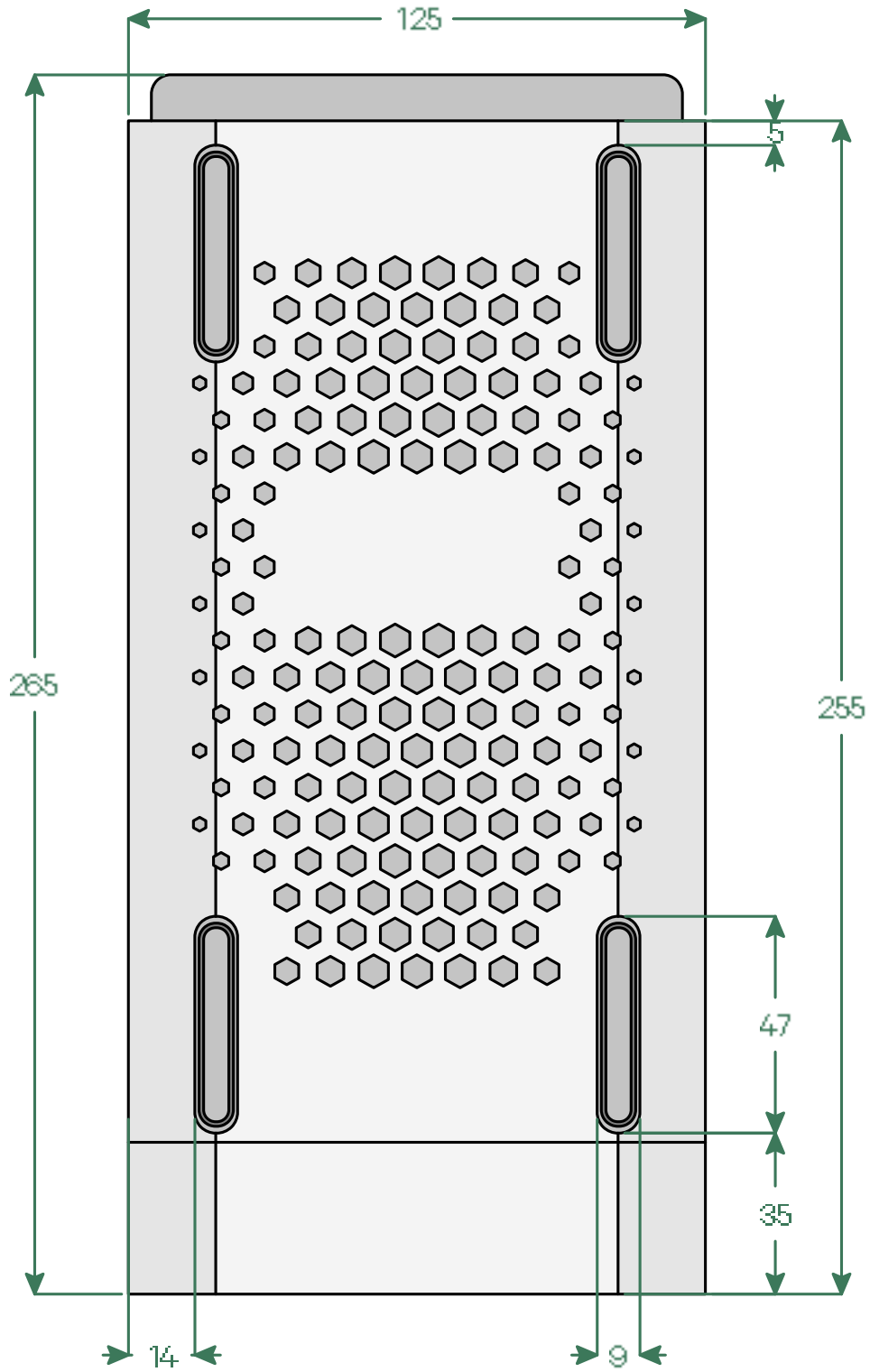

## 5. Troubleshooting tips

Do not open the housing of the **Scape® Tangible and Silent PC** by yourself.

If your devices do not work as intended, contact **Interactive Scape Hardware Support**. You can reach them on weekdays at **+49 30 698 094 150**.

### 5.1. Manufacturer – Support

Interactive Scape GmbH  
Wilhelmine-Gemberg-Weg 6  
10179 Berlin  
Germany

+49 (0)30 698 094 150



**Interactive Scape GmbH**

Wilhelmine-Gemberg-Weg 6, D-10179 Berlin

T +49 30 69 809 41-00, F +49 30 69 809 429

[www.interactive-scape.com](http://www.interactive-scape.com), [info@interactive-scape.com](mailto:info@interactive-scape.com)