

Scape X[®]

Tags

Shapes

Magnify

sxtv-001 / sxti-001 / sxsi-001 / sxsv-001 /
sxmi-001 / sxmv-001

Operating manual

Scape X[®] Tags & Shapes

Contents

1. General	6
1.1. Safety instructions	6
1.2. Cleaning information	7
1.3. Transport information	7
2. Instruction for use	8
3. Troubleshooting	9
3.1. Manufacturer – Support	9
4. Annex	10
4.1. Technical drawings - Scape X [®] Tags Visible (sxtv-001)	10
4.1.1. Perspective	10
4.1.2. Top view	11
4.1.3. Right view	12
4.2. Technical specifications - Scape X [®] Tags Visible (sxtv-001)	13
4.3. Technical drawings - Scape X [®] Tags Invisible (sxti-001)	14
4.3.1. Perspective	14
4.3.2. Top view	15
4.3.3. Right view	16
4.4. Technical specifications - Scape X [®] Tags Invisible (sxti-001)	17
4.5. Technical drawings - Scape X [®] Shape Invisible (sxsi-001)	18
4.5.1. Perspective	18
4.5.2. Top view	19
4.5.3. Right view	20
4.6. Technical specifications - Scape X [®] Shape Invisible (sxsi-001)	21
4.7. Technical drawings - Scape X [®] Shape Visible (sxsv-001)	22
4.7.1. Perspective	22
4.7.2. Top view	23
4.7.3. Right view	24
4.8. Technical specifications - Scape X [®] Shape Visible (sxsv-001)	25
4.9. Technical drawings - Scape X [®] Magnify Invisible (sxmi-001)	26
4.9.1. Perspective	26
4.9.2. Top view	27
4.9.3. Right view	28
4.10. Technical specifications - Scape X [®] Magnify Invisible (sxmi-001)	29
4.11. Technical drawings - Scape X [®] Magnify Visible (sxmv-001)	30
4.11.1. Perspective	30
4.11.2. Top view	31
4.11.3. Right view	32
4.12. Technical specifications - Scape X [®] Magnify Visible (sxmv-001)	33

Notes

This manual is applicable for the following objects only:

- Scape X® Tags Visible (sxtv-001)
- Scape X® Tags Invisible (sxti-001)
- Scape X® Shape Invisible (sxsi-001)
- Scape X® Shape Visible (sxsv-001)
- Scape X® Magnify Invisible (sxmi-001)
- Scape X® Magnify Visible (sxmv-001)

Information in this document is subject to change without notice.

©2021 Interactive Scape GmbH. All rights reserved.

The document or excerpts from the document may not be duplicated without the prior permission of Interactive Scape GmbH.

Interactive Scape GmbH shall not be liable for any errors contained in this document or any other incidental or consequential damages resulting from the delivery, use or application of this material.

All product names mentioned in this document are trademarks or registered trademarks of their respective owners.

1. General

This manual describes the proper use of **Scape X® Tags Scape X® Shapes and Scape X® Magnify**. Please be aware of any additional documents that may be required.

In order for the objects to function on a **Scape® Tangible** touchscreen, the **Scape X® Objectrecognition Module** must be activated in the **Touch and Object Assistant** of the screen, if not already configured. For more information, refer to the **Touch and Object Assistant** manual.

Stable functionality of the objects is only guaranteed when used on **Scape® Tangible** touchscreens from Interactive Scape GmbH.

1.1. Safety instructions

Follow these safety precautions before and during the use of your **Scape X® Objects** to protect yourself, your environment, and the **Scape X® Objects** from damage.

Moisture, liquids and vapours

Moisture, liquids and vapours can impair the functionality of your **Scape X® Objects** and your **Scape® Tangibles**. In particular, the undersides of the objects should always be kept completely dry during use.

- Use the **Scape X® Objects** only inside buildings.
- Do not allow the **Scape X® Objects** to come into contact with liquids.
- Protect your **Scape X® Objects** from vapors and moisture.

Improper cleaning

Improper cleaning with strong detergents and solvents or dripping wet cloths can damage the **Scape X® Objects**.

- Please observe the information on cleaning your **Scape X® Objects** (Chapter 1.2 Cleaning information).

Improper opening and repair

Improper opening and repair can cause **Scape X® Objects** to lose their functionality and damage the surface of the **Scape® Tangible**.

- Do not open the object housings.
- If repairs are required, contact the manufacturer or a specialist dealer.

Load and damage to the surface

Rough or sharp-edged materials can particularly damage the underside of **Scape X® Tags** or **Scape X® Shapes** and impair object recognition.

- Do not place heavy items on top of the objects.
- Store objects only on smooth or soft surfaces.
- Do not use objects with a dirty underside or on dirty screens.

1.2. Cleaning information

Scape X® Objects usually do not need to be maintained. Nevertheless, it is recommended to clean the surfaces regularly to avoid scratching the undersides of the **Scape X® Objects**

Clean the undersides of the **Scape X® Objects** regularly before and during use to avoid scratching the screen surface.

- Commercially available plastic cleaner is suitable for cleaning the surfaces.
- Apply the solution to a soft, lint-free cloth. Avoid coarse materials.
- Do not use microfibre cloths to clean the glass surfaces.
- Moisten the cloth and clean the **Scape X® Objects** from all sides. Apply the liquid only to the cloth and never directly to the object. This will prevent liquid from penetrating inside the object.

1.3. Transport information

Always transport your **Scape X® Objects** adequately padded and protected against moisture. It is generally recommended to use the original packaging.

2. Instruction for use

Remove the film on the underside (white film) of the Scape X® Objects before use.

Transparent **Scape X® Objects** are protected by a film on the top and bottom side.

Attach Scape X® Tags to an object for use.

Scape X® Tags (not **Scape X® Shape Invisible**) should not be touched directly during use. Direct contact with conductive materials influences object recognition.

Do not attach objects made of conductive materials directly to Scape X® Tags.

To attach objects made of conductive materials to **Scape X® Tags**, insert a layer of non-conductive material between **Scape X® Tags** and object. Cardboard, acrylic or wood, for example, can be used as intermediate material.

The thickness of the intermediate material must be **at least 10mm**.

Conductive material that extends beyond the **Scape X® Tag** or the intermediate material must have a minimum distance of **12mm** to the display.

Scape X® Tags must always lie completely and flat on the display.

Scape X® Tags must not be bent. Pay particular attention when removing stuck objects.

Temperatures above 60°C will damage or destroy your Scape X® Tags or Scape X® Shapes.

If you have any questions regarding the use of **Scape X® Tags** or **Scape X® Shapes** or their installation on objects or if you are uncertain, please contact the **Interactive Scape Hardware Support**.

You can reach them on weekdays at **+49 30 698 094 150**.

3. Troubleshooting

Do not open the housing of the **Scape X® Objects** yourself.

If your **Scape X® Objects** do not work as intended, contact **Interactive Scape Hardware Support**. You can reach them on weekdays at +49 30 698 094 150.

3.1. Manufacturer – Support

Interactive Scape GmbH
Wilhelmine-Gemberg-Weg 6
10179 Berlin

+49 (0)30 698 094 150

4. Annex

4.1. Technical drawings - Scape X® Tags Visible (sxtv-001)

4.1.1. Perspective



4.1.2. Top view

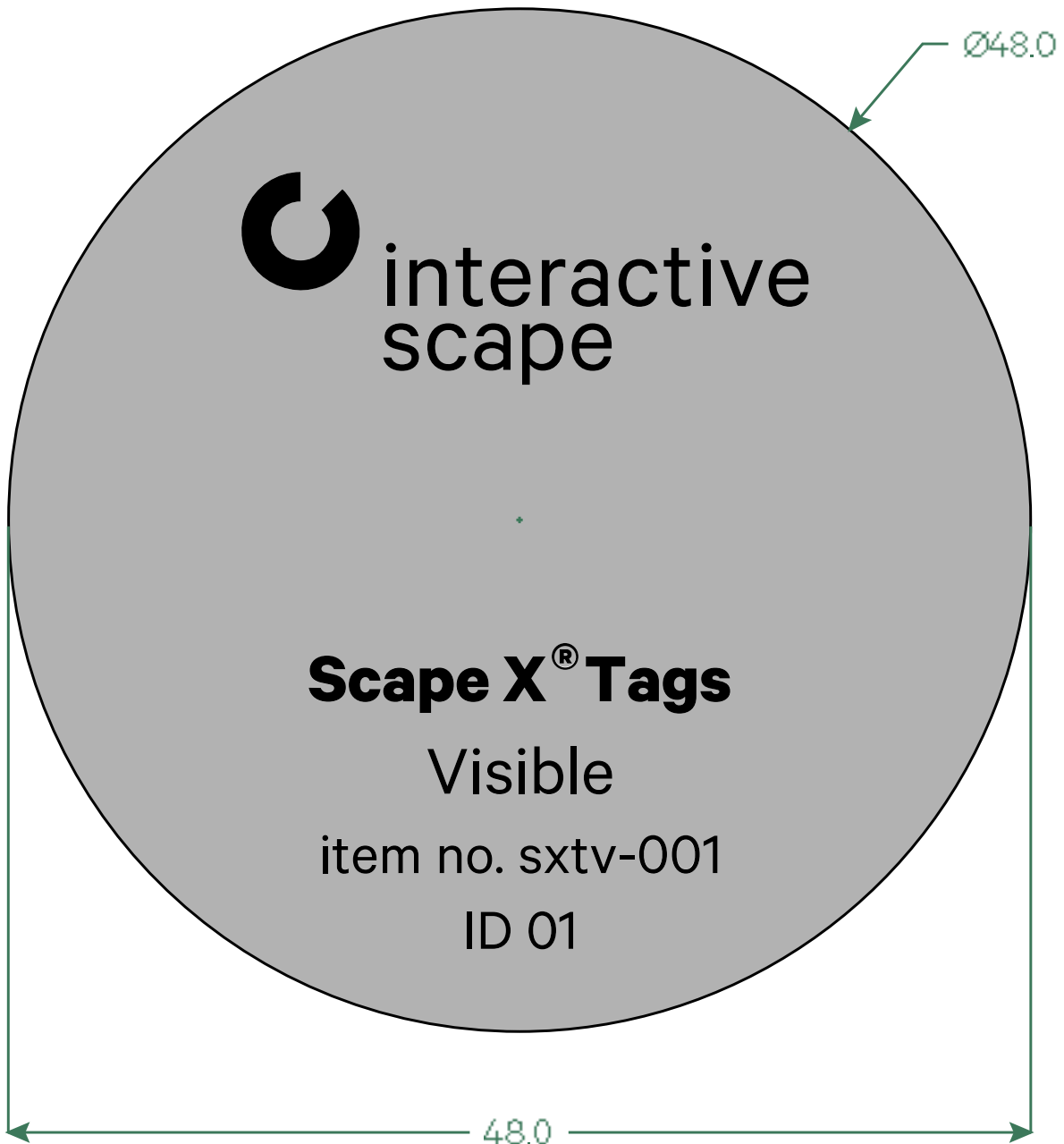

4.1.3. Right view

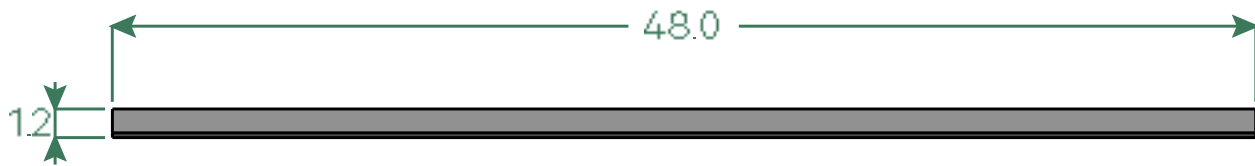

4.2. Technical specifications - Scape X® Tags Visible (sxtv-001)

Article Number	sxtv-001
Dimensions	ø: 48.0 mm, h: 1.2 mm
Weight	3.4 g

Material

Object	Acrylic, black
Printing	foil 6c, printed

Features

TUIO IDs	1 - 24
Rotational angular precision	< 1°, 0° adjustable
Compatible with	Scape® Tangible Displays 32" / 43" / 55" / 65" with Scape X® Object Recognition Module

4.3. Technical drawings - Scape X® Tags Invisible (sxti-001)

4.3.1. Perspective

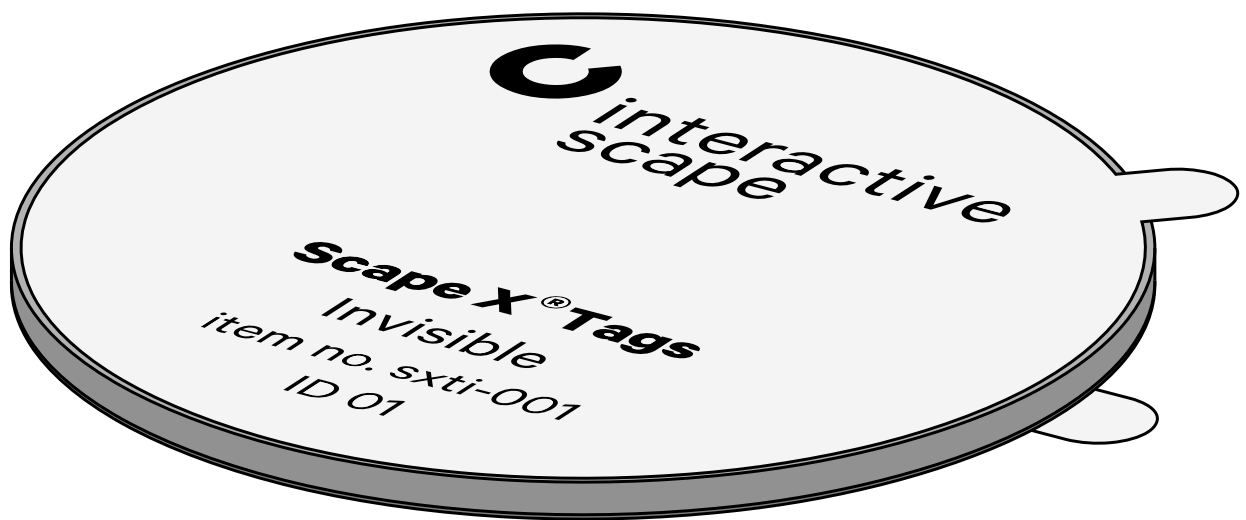

4.3.2. Top view

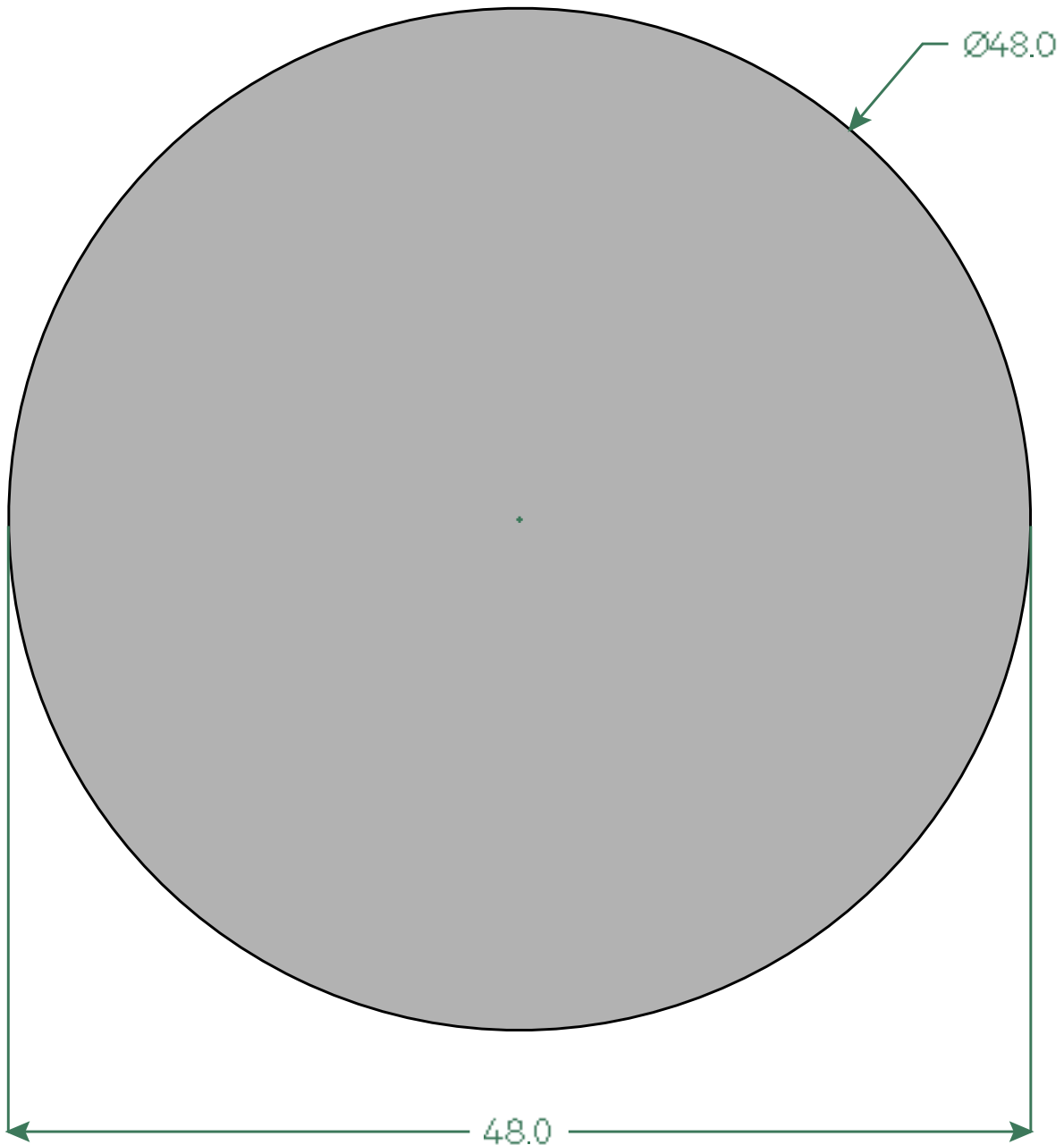

4.3.3. Right view

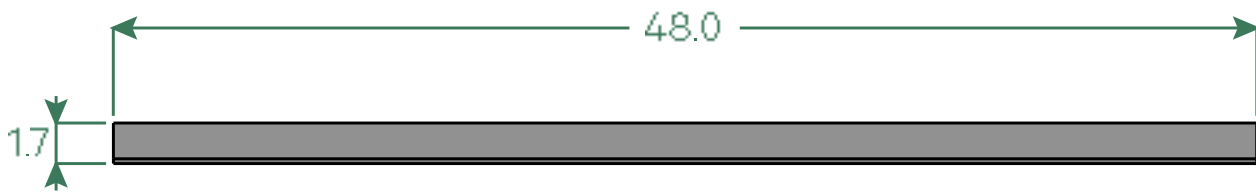

4.4. Technical specifications - Scape X® Tags Invisible (sxti-001)

Article Number	sxti-001
Dimensions	ø: 48.0 mm, h: 1.7 mm
Weight	3.5 g

Material

Object	Acrylic, transparent
--------	----------------------

Features

TUIO IDs	1 - 24
Rotational angular precision	< 1°, 0° adjustable
Compatible with	Scape® Tangible Displays 32" / 43" / 55" / 65" with Scape X® Object Recognition Module

4.5. Technical drawings - Scape X® Shape Invisible (sxsi-001)

4.5.1. Perspective



4.5.2. Top view

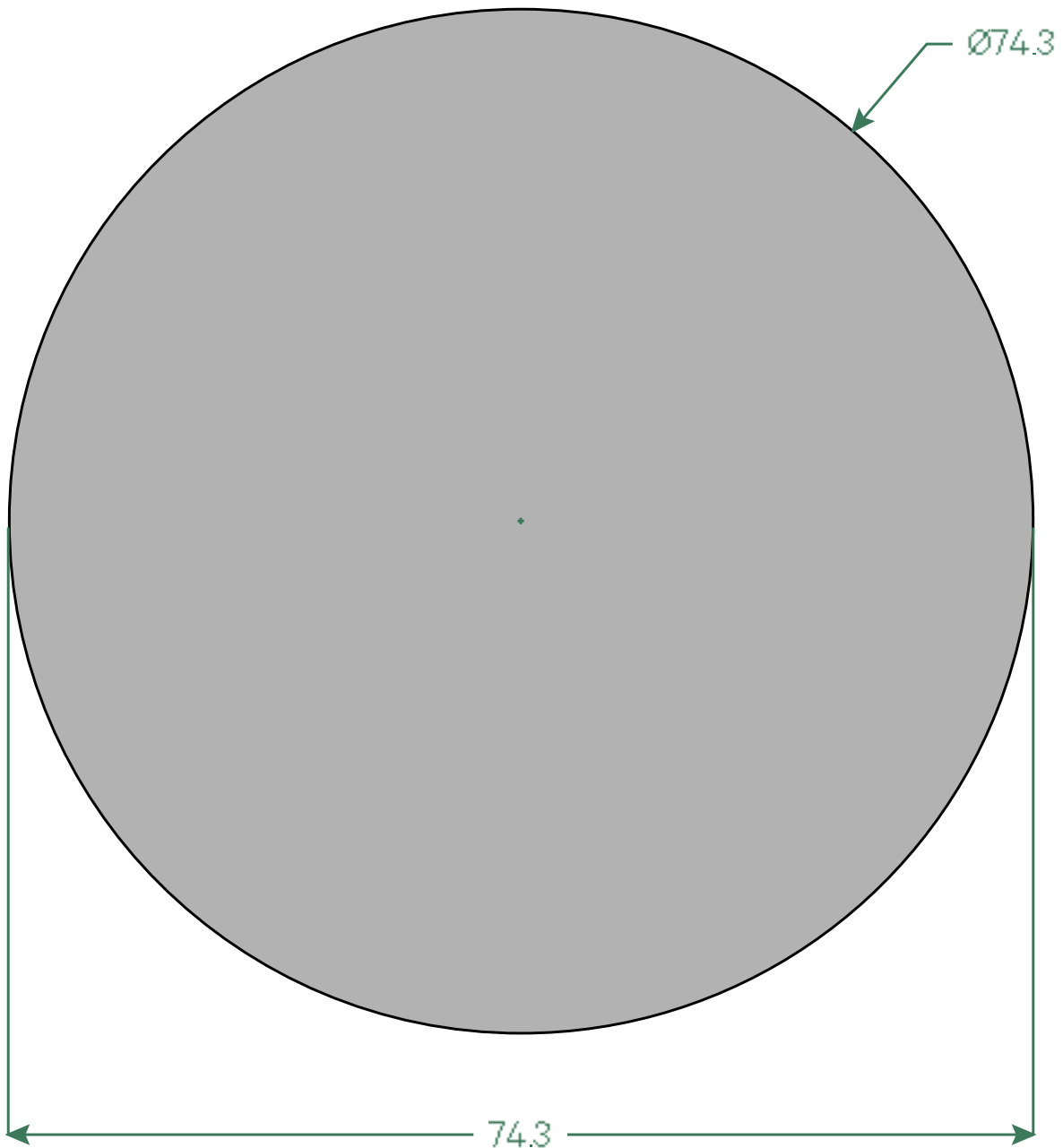

4.5.3. Right view

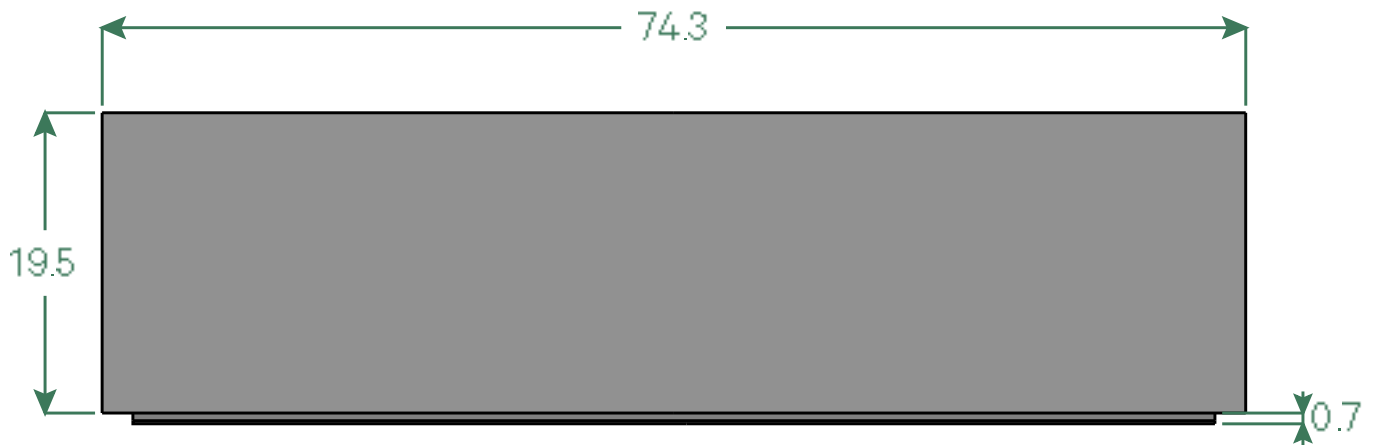

4.6. Technical specifications - Scape X® Shape Invisible (sxsi-001)

Article Number	sxsi-001
Dimensions	ø: 74.3 mm, h: 20.2 mm (19.5 mm + 0.7 mm)
Weight	98.4 g

Material

Object	Acrylic, transparent
--------	----------------------

Features

TUIO IDs	1 - 12
Rotational angular precision	< 1°, 0° adjustable
Compatible with	Scape® Tangible Displays 32" / 43" / 55" / 65" with Scape X® Object Recognition Module

4.7. Technical drawings - Scape X® Shape Visible (sxsxv-001)

4.7.1. Perspective

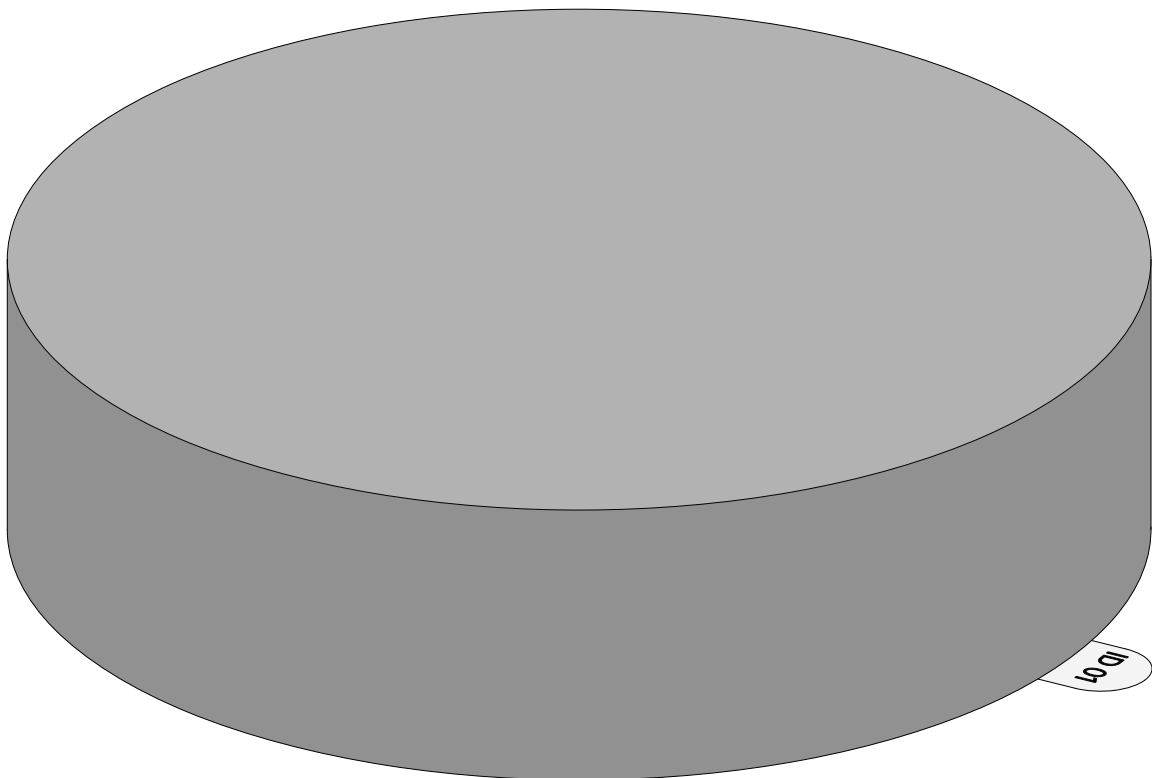

4.7.2. Top view

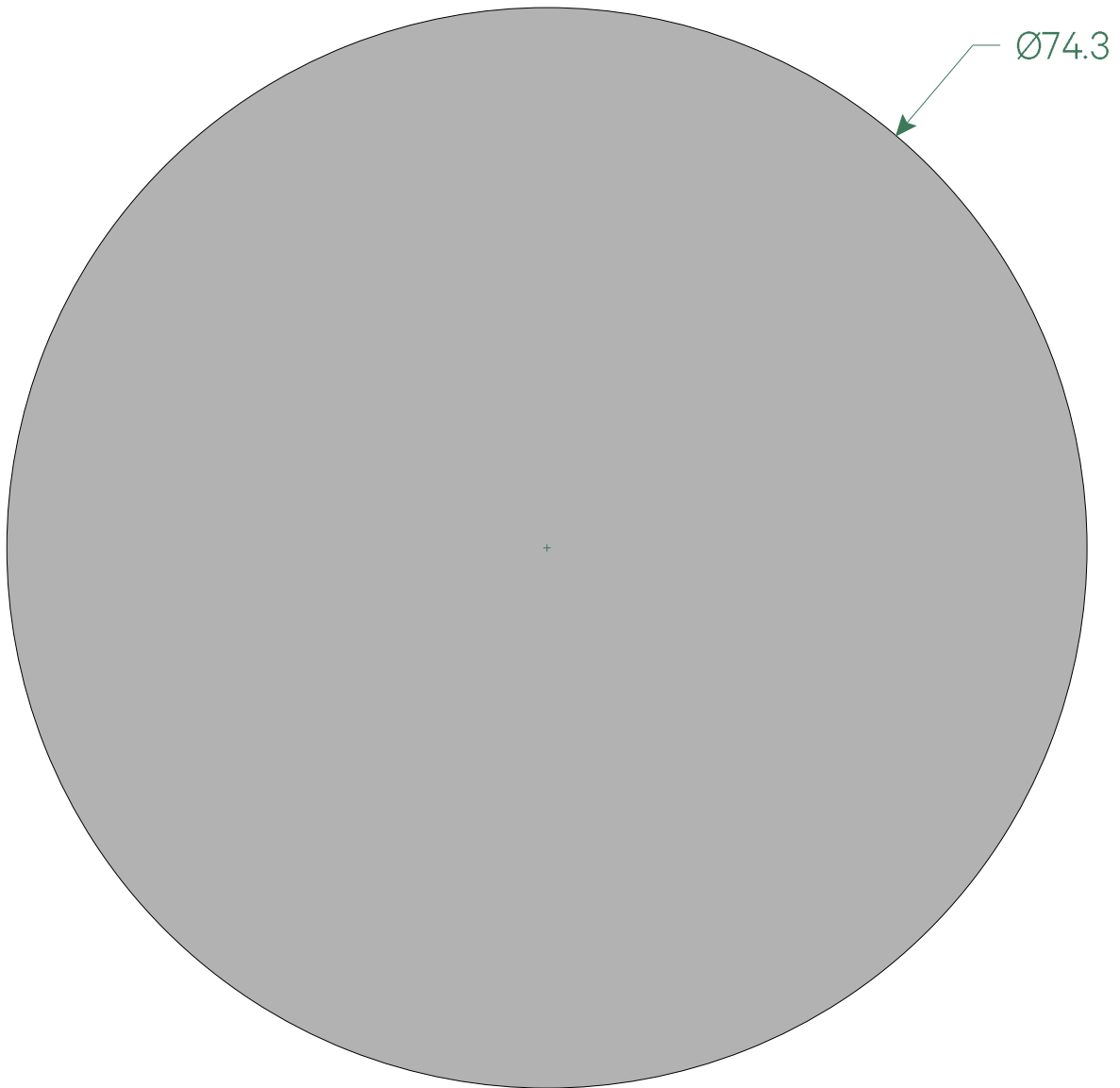

4.7.3. Right view

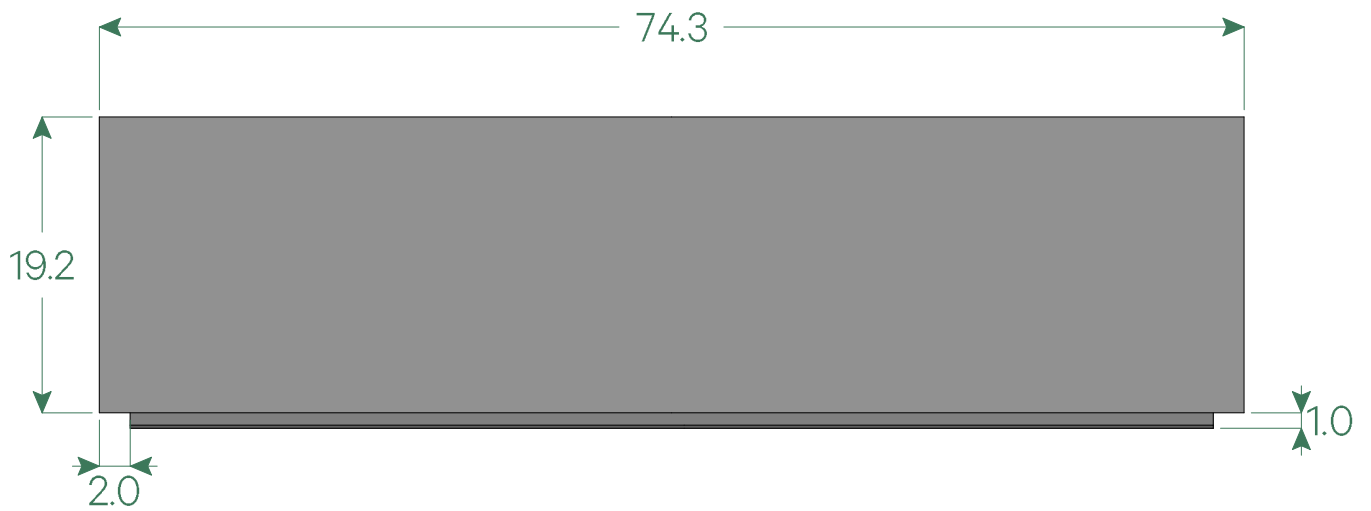

4.8. Technical specifications - Scape X® Shape Visible (sxsxv-001)

Article Number	sxsi-001
Dimensions	ø: 74.3 mm, h: 20.2 mm (19.2 mm + 1.0 mm)
Weight	98.4 g

Material

Object	Polyurethan – Obomodulan 1700, black
--------	--------------------------------------

Features

TUIO IDs	1 - 12
Rotational angular precision	< 1°, 0° adjustable
Compatible with	Scape® Tangible Displays 32" / 43" / 55" / 65" with Scape X® Object Recognition Module

4.9. Technical drawings - Scape X® Magnify Invisible (sxmi-001)

4.9.1. Perspective

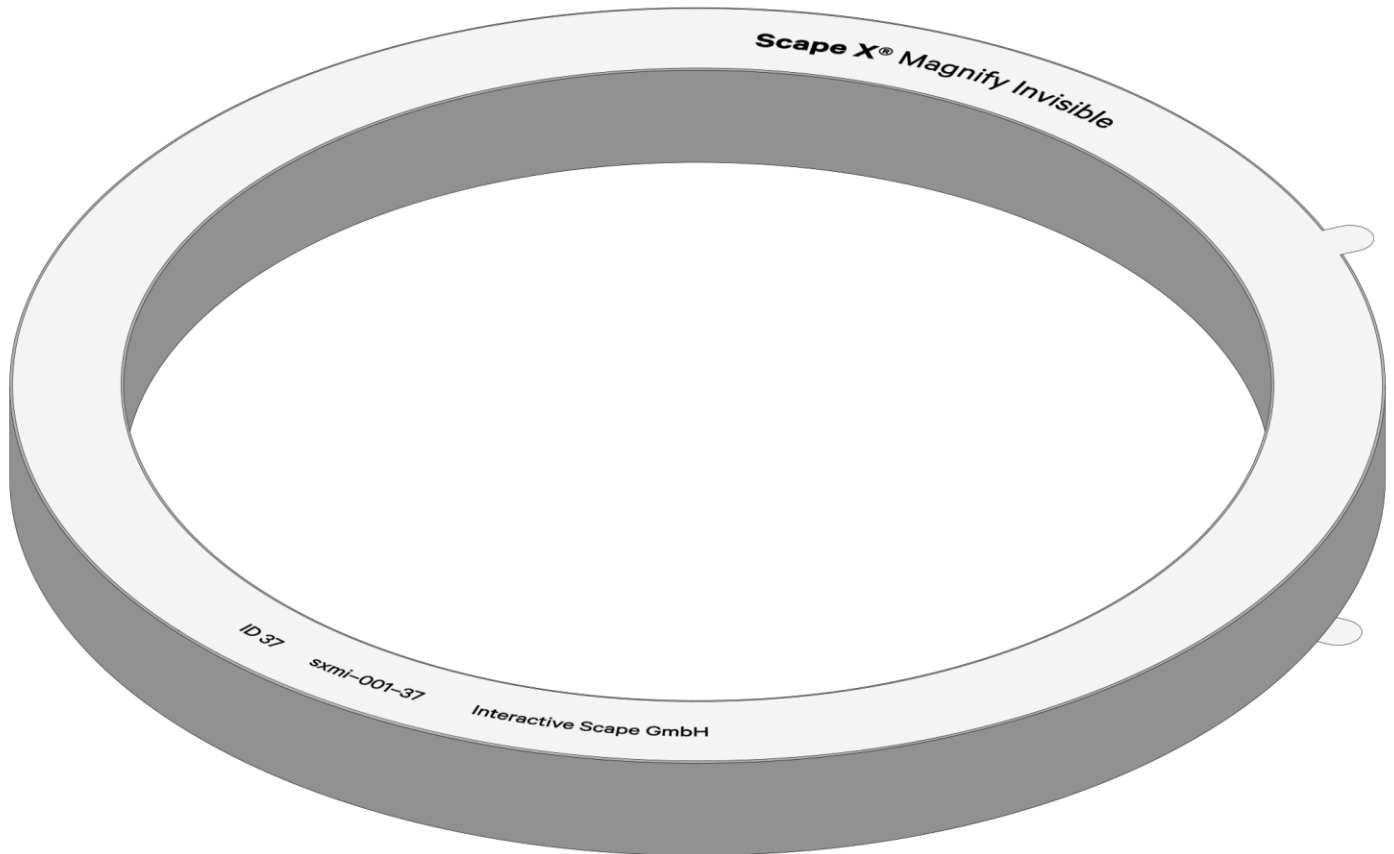

4.9.2. Top view

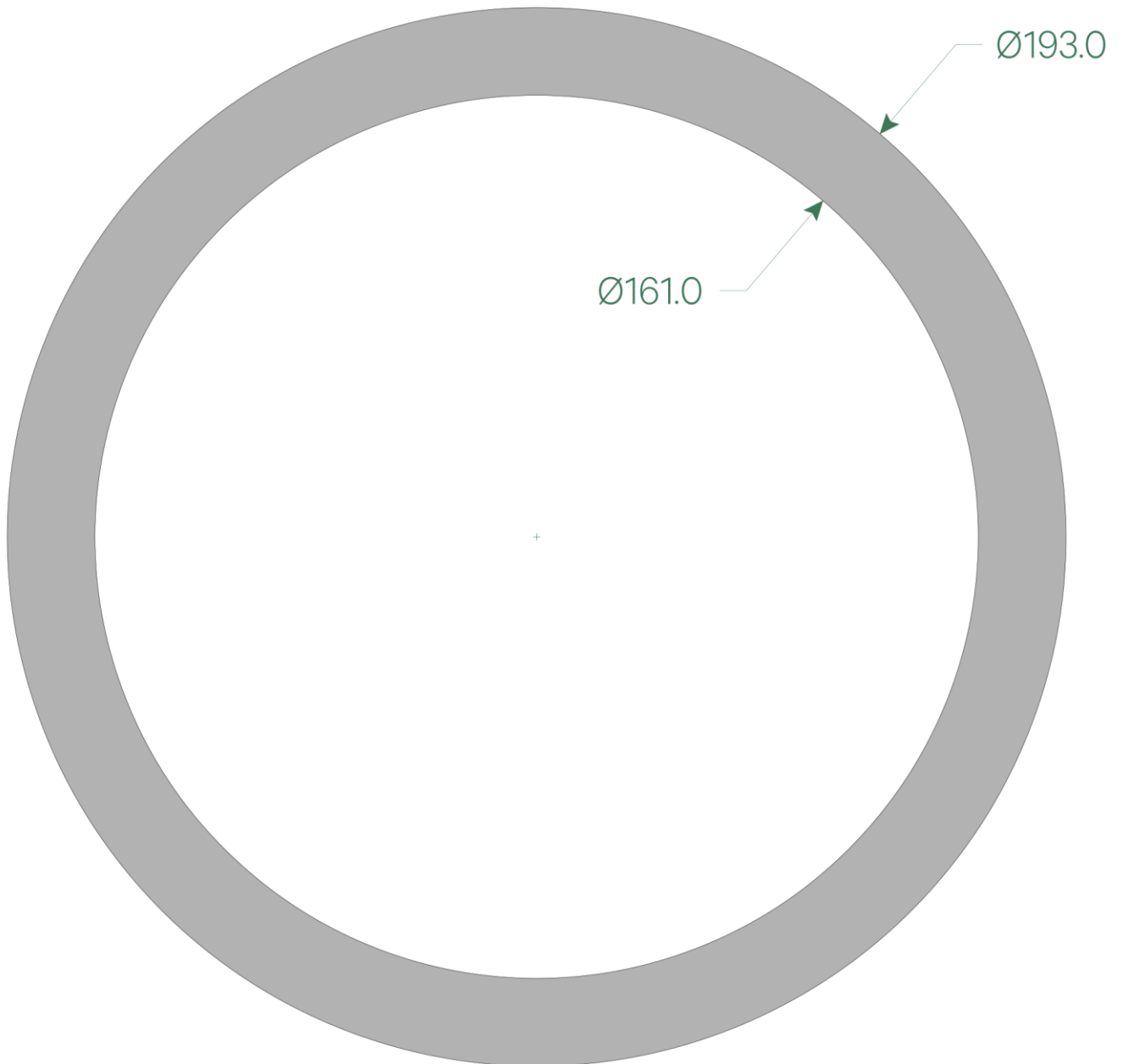

4.9.3. Right view



4.10. Technical specifications - Scape X® Magnify Invisible (sxmi-001)

Article Number	sxmi-001
Dimensions	inner ø: 161.0 mm, outer ø: 193.0mm, h: 15.2 mm
Weight	160.0 g

Material

Object	Acrylic, transparent
--------	----------------------

Features

TUIO IDs	37 / 38
Rotational angular precision	< 1°, 0° adjustable
Compatible with	Scape® Tangible Displays 32" / 43" / 55" / 65" with Scape X® Object Recognition Module

4.11. Technical drawings - Scape X® Magnify Visible (sxmlv-001)

4.11.1. Perspective

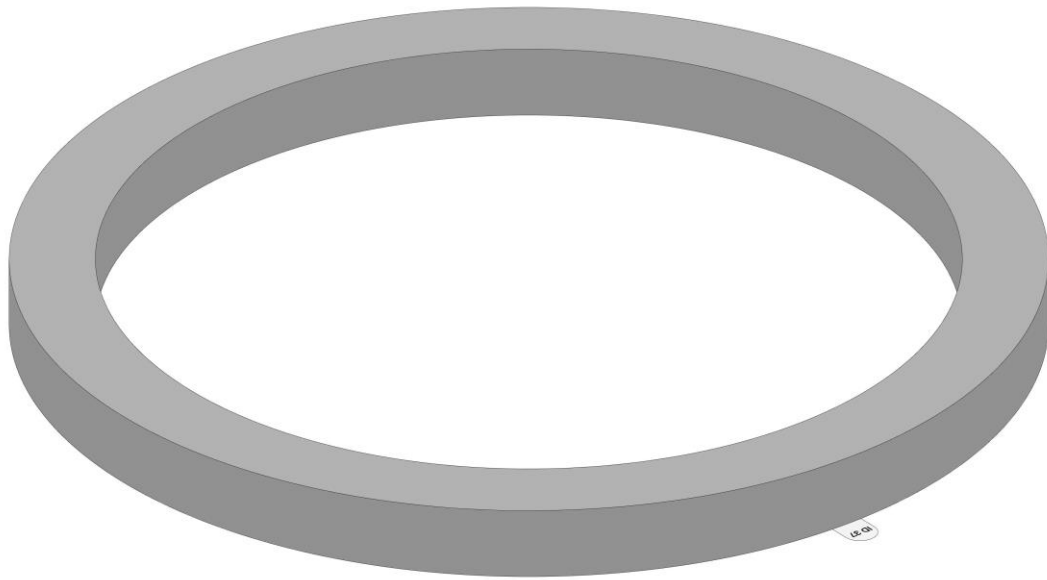

4.11.2. Top view



4.11.3. Right view



4.12. Technical specifications - Scape X® Magnify Visible (sxmv-001)

Article Number	sxmi-001
Dimensions	inner ø: 161.0 mm, outer ø: 193.0mm, h: 15.2 mm
Weight	160.0 g

Material

Object	Polyurethan – Obomodulan 1700, black
--------	--------------------------------------

Features

TUIO IDs	37 / 38
Rotational angular precision	< 1°, 0° adjustable
Compatible with	Scape® Tangible Displays 32" / 43" / 55" / 65" with Scape X® Object Recognition Module

Interactive Scape GmbH

Wilhelmine-Gemberg-Weg 6, D-10179 Berlin

T +49 30 69 809 41-00, F +49 30 69 809 429

www.interactive-scape.com, info@interactive-scape.com